

# PD525S

High Output, Dual 15" Low-Frequency / Subwoofer Loudspeaker



## SPEC SHEET

### FEATURES ■

- Two high power 380 mm (15 in) low frequency drivers
- Low frequency extension to 40 Hz
- Enclosure dimensions compatible with all PD500 Series models

### APPLICATIONS ■

- Sports Facilities
- Performance spaces
- Auditoriums
- Worship facilities

The **PD525S** is a high power low frequency loudspeaker comprised of two 380 mm (15 in) Dual Coil - Dual Gap Differential Drive®, low frequency drivers in a frontloaded, vented configuration. The trapezoidal cabinet is fitted with M10 threaded suspension points.

It is intended for use as a flown high power low frequency module used in conjunction with all full-range PD500 Series loudspeakers.

The **PD525S** will perform well in any application where high output low-frequency is required.

The dual 2275H low-frequency drivers deliver excellent low frequency extension with minimal power compression and low distortion plus high sensitivity and power handling. Multiple vents assures minimal port compression and low distortion at high output levels.

Standard finish is black DuraFlex™, with white available as a no-cost option. Weather resistant and unpainted versions are also available.



### SPECIFICATIONS ■

Frequency Range <sup>1</sup> (-10 dB)	28 Hz to 3.8kHz
Frequency Response <sup>1</sup> (±3 dB)	40 Hz to 1.1kHz
Transducer Power Ratings (AES) <sup>1</sup>	2000 W (8000 W peak) 2 hrs
System Power Rating <sup>2</sup>	1000 W, 100 hrs
Sensitivity (1W @ 1m) <sup>3</sup>	102 dB (avg 40-1kHz)
Maximum SPL <sup>4</sup>	135 dB cont (141 dB peak)
Input Modes	Drivers Parallel/Drivers Discrete

### Transducers

Low Frequency Driver	2 x JBL 2275H 380 mm (15 in) Dual Coil - Dual Gap Differential Drive®, drivers with 75mm (3") voice coil
----------------------	--

# PD525S

High Output, Dual 15" Low-Frequency / Subwoofer Loudspeaker



## SPEC SHEET

### SPECIFICATIONS (Cont.) ■

#### Physical

Enclosure	Trapezoidal with 10 degree side angles, 18 mm exterior grade 11-ply Finnish birch plywood.
Suspension Attachment	20 points (5 top, 5 bottom, 4 each side, 2 rear), M10 threaded hardware (eyebolts NOT included, see optional accessories).
Finish	Black DuraFlex™ finish. White (-WH) available upon request.
Optional Weather Resistant Versions	WRC for outdoor placement where the loudspeaker will be sheltered from direct exposure to the elements. WRX for direct exposure or extreme environments, such as tropical or beach, or in areas with salt air, extreme high humidity or rapid changes in temperature. See WRC/WRX configuration sheet for details.
Grille	Powder coated 14 gauge perforated steel, acoustically transparent backing.
Input Connectors	CE-compliant covered barrier strip terminals. Barrier terminals accept up to 5.2 sq mm (10 AWG) wire or max width 8 mm (.315 in) spade lugs. This input connectivity applies to all PD500 models, including WRC & WRX versions.
Environmental Specifications	IP55C per IEC 529
Dimensions (H x W x D in vertical orientation)	782 x 783 x 670 mm (30.8 x 30.8 x 26.4 in)
Net Weight	53.4 kg (118 lb)
Optional Accessories	229-00009-01 kit of three M10 x 35 mm forged shoulder steel eyebolts.

### FREQUENCY RESPONSE (MAIN TUNING) ■

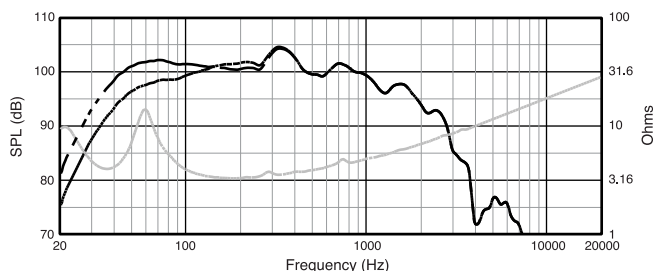

#### SPECIFICATIONS NOTES

- 1 AES standard, one decade pink noise with 6 dB crest factor within device's operational band, free air. Standard AES 2 hr rating plus longterm 100 hr rating are specified for low-frequency transducers.
- 2 AES standard, one decade pink noise with 6 dB crest factor, in cabinet, long-term 100 hr rating.
- 3 Half-space (2π) loading, average in specified frequency band.
- 4 Calculated based on power rating and sensitivity, exclusive of power compression.

JBL continually engages in research related to product improvement. Some materials, production methods and design refinements are introduced into existing products without notice as a routine expression of that philosophy. For this reason, any current JBL product may differ in some respect from its published description, but will always equal or exceed the original design specifications unless otherwise stated.

# PD525S

High Output, Dual 15" Low-Frequency / Subwoofer Loudspeaker



## SPEC SHEET

### PRODUCT DIMENSIONS ■

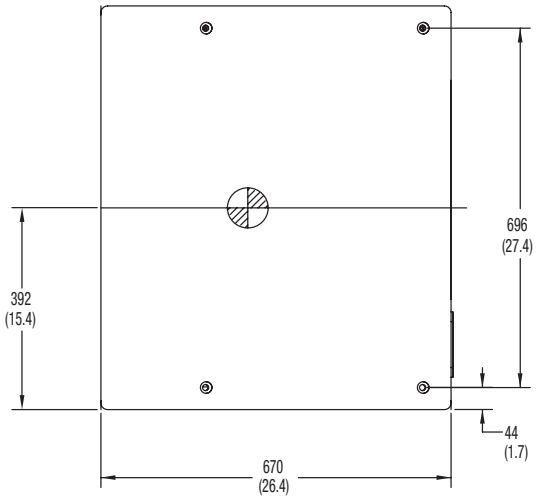
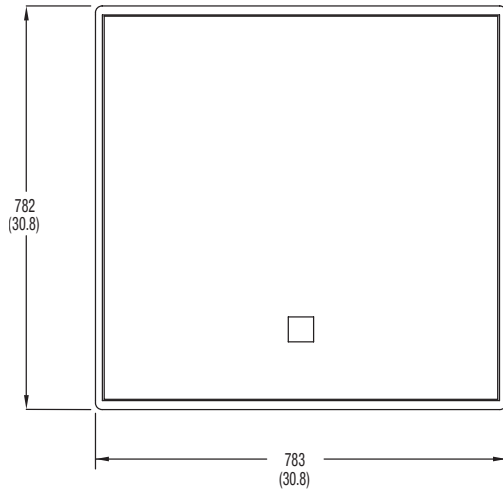
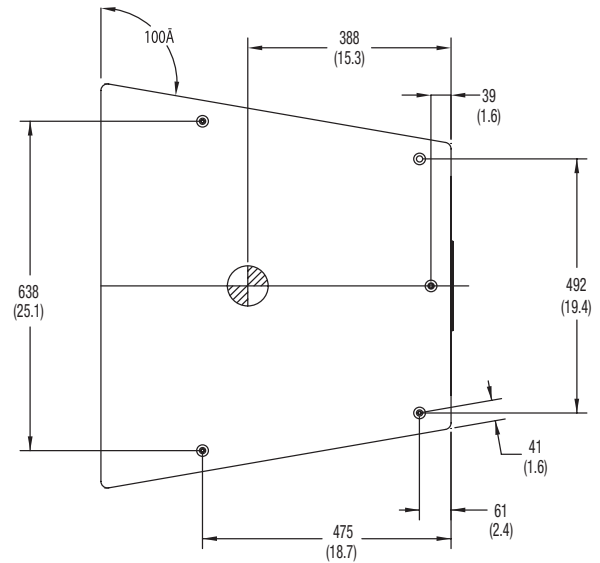

HARMAN Professional 8500 Balboa Blvd. Northridge, CA 91329 USA

1000228294B  
5146184B-00  
04/2024

© 2024 HARMAN International Industries, Incorporated. All rights reserved.  
Features, specifications and appearance are subject to change without notice.

[www.jblpro.com](http://www.jblpro.com)

Page 3/3