

## Premium Power Protection for Mission Critical Applications

- *Power conditioning*
- *Outage protection*
- *Rackmount or tower format*



Online double conversion UPS solution offers power conditioning and outage protection in a compact and flexible rack or tower format. With near unity power factor operation (2U units), the UPS provides maximum usable power to equipment and protects it with a standard 3-year warranty (or optional 5-year extended warranty). The 2U models provide scalable battery capacity when extended protection is required; the powerful charger can provide up to 8 amps of current to quickly recharge up to 7 matching battery packs (ordered separately).

### **FEATURES**

- Available Power Ratings. . . . . 1000VA (1U/2U), 1500VA, 2000VA, 3000VA
- High Output Power Factor . . . Provides near unity output power factor rating (2U units)
- Efficient Operation . . . . . Up to 98% ECO mode efficiency lowers energy consumption.
- Charging Current . . . . . 1/2/4/6/8A, adjustable from LCD display. Optimize charging for most battery solutions (2U units)
- Multiple Communications. . . . The UPS9A Series offers capability for communications via RS-232 and USB. See the accessories section below to add modules to accommodate more formats.
- Programmable Receptacles. . Remote on/off control (2U units)
- Hot Swappable Battery . . . . . Replace battery without interrupting the load.
- Fast Recharge . . . . . Up to 95% in just 3 hours (2U units)
- Mounting Formats . . . . . Rackmount: 1U and 2U models include a 4-point rackmount rail kit with horizontal brackets. See chart on page 2 for minimum depth requirements.  
Tower Pedestals: 2U models also include pedestals for non-rackmount applications.
- Compliance . . . . . UL, cUL, RoHS, TAA compliant (UPS only). See chart on page 3 for more.
- Warranty . . . . . 3 year warranty on electronics and battery (U.S. and Canada)

### **ACCESSORIES (order separately)**

- Maintenance Bypass . . . . . Bypass module enables the UPS to be replaced or serviced without interruption of power to critical loads. (UPS-XBDM-20RCD w/cord)
- Expansion Battery Pack. . . . . External battery packs for extended run times are available for 1500VA, 2000VA and 3000VA UPS. (see chart on pg. 2)
- Dry Contact Card. . . . . Form C relay dry contact closures for remote monitoring. (UPS-RELAY)
- SNMP Card . . . . . Internal card with software allows monitoring and control of remotely connected UPS from a web browser. (UPS-SNMP)
- Environmental Sensor . . . . . Works with the SNMP card to detect variations in temperature/humidity, and the presence of water. (UPS-SNMP-EMP)
- Extended Warranty . . . . . Five year warranty on electronics and battery. Warranty must be purchased at the same time as the UPS. (see chart on pg. 2)

## UPS9A SERIES OVERVIEW

| Model No.          | Description                                                  | 4-pt.<br>Rail kit | Tower<br>pedestals | UPS overall<br>depth * | UPS mounting<br>depth w/rail kit ** | Minimum rack<br>depth *** |
|--------------------|--------------------------------------------------------------|-------------------|--------------------|------------------------|-------------------------------------|---------------------------|
| <b>UPS</b>         |                                                              |                   |                    |                        |                                     |                           |
| UPS9AC-1000        | Online UPS 1000VA (800W), 1U                                 | ✓                 |                    | 18.8"                  | 17.8"                               | 22"D                      |
| UPS9A-1000         | Online UPS 1000VA (1000W), 2U                                | ✓                 | ✓                  | 16.1"                  | 15.1"                               | 22"D                      |
| UPS9A-1500         | Online UPS 1500VA (1450W), 2U                                | ✓                 | ✓                  | 16.1"                  | 15.1"                               | 22"D                      |
| UPS9A-2000         | Online UPS 2000VA (1930W), 2U                                | ✓                 | ✓                  | 20"                    | 19"                                 | 27"D                      |
| UPS9A-3000         | Online UPS 3000VA (2880W), 2U                                | ✓                 | ✓                  | 24.8"                  | 23.8"                               | 32"D                      |
| <b>Accessories</b> |                                                              |                   |                    |                        |                                     |                           |
| UPS-RELAY          | Dry contact card relay control                               |                   |                    |                        |                                     |                           |
| UPS-SNMP           | Internal SNMP card                                           |                   |                    |                        |                                     |                           |
| UPS-SNMP-EMP       | Environmental monitoring sensor (works w/UPS-SNMP)           |                   |                    |                        |                                     |                           |
| UPS-XBDM-20RCD     | Corded bypass module (for UPS9A-2000)                        |                   |                    |                        |                                     |                           |
| UPS-XBPA-36        | Expansion battery pack, 2U (for UPS9A-1500)                  | ✓                 | ✓                  |                        |                                     |                           |
| UPS-XBPA-36E       | Expansion battery pack, 2U (for UPS9A-1500)                  | ✓                 | ✓                  |                        |                                     |                           |
| UPS-XBPA-48        | Expansion battery pack, 2U (for UPS9A-2000)                  | ✓                 | ✓                  |                        |                                     |                           |
| UPS-XBPA-72        | Expansion battery pack, 2U (for UPS9A-3000)                  | ✓                 | ✓                  |                        |                                     |                           |
| UPS-EW-522         | Extended 5 year warranty (for UPS9A-1000, 1500; UPS9AC-1000) |                   |                    |                        |                                     |                           |
| UPS-EW-523         | Extended 5 year warranty (for UPS9A-2000, 3000)              |                   |                    |                        |                                     |                           |
| UPS-EW-524         | Extended 5 year warranty (for external battery packs)        |                   |                    |                        |                                     |                           |
| UPS-RBT1-370       | REPLACEMENT battery tray (for UPS9A-1000)                    |                   |                    |                        |                                     |                           |
| UPS-RBT2-371       | REPLACEMENT battery tray (for UPS9A-1500)                    |                   |                    |                        |                                     |                           |
| UPS-RBT3-372       | REPLACEMENT battery tray (for UPS9A-2000)                    |                   |                    |                        |                                     |                           |
| UPS-RBT4-373       | REPLACEMENT battery tray (for UPS9A-3000)                    |                   |                    |                        |                                     |                           |
| <b>Bundles</b>     |                                                              |                   |                    |                        |                                     |                           |
| UPS9A-1000-IP      | UPS9A-1000 + UPS-SNMP                                        | ✓                 | ✓                  |                        |                                     |                           |
| UPS9A-1500-IP      | UPS9A-1500 + UPS-SNMP                                        | ✓                 | ✓                  |                        |                                     |                           |
| UPS9A-2000-IP      | UPS9A-2000 + UPS-SNMP                                        | ✓                 | ✓                  |                        |                                     |                           |
| UPS9A-3000-IP      | UPS9A-3000 + UPS-SNMP                                        | ✓                 | ✓                  |                        |                                     |                           |

\* UPS Overall Depth: UPS chassis with front bezel.

\*\* UPS Mounting Depth: Dimensions of UPS mounted in a rack from front rack rail to rear of UPS (bezel extends approx. 1" beyond front rack rail).

\*\*\* Minimum Rack Depth: For Lowell floor-standing racks (contact Lowell for other rack styles)



## SPECIFICATIONS

| LOWELL MODEL NO.         |                            | UPS9AC-1000                                                                                                                                                           | UPS9A-1000                                     | UPS9A-1500     | UPS9A-2000         | UPS9A-3000               |
|--------------------------|----------------------------|-----------------------------------------------------------------------------------------------------------------------------------------------------------------------|------------------------------------------------|----------------|--------------------|--------------------------|
| CAPACITY                 | Power rating               | 1000VA (800W)                                                                                                                                                         | 1000VA (1000W)                                 | 1500VA (1450W) | 2000VA (1930W)     | 3000VA (2880W)           |
| INPUT                    | Voltage/frequency          | 50–150VAC* / 50/60Hz auto-sensing                                                                                                                                     |                                                |                |                    |                          |
| OUTPUT                   | Voltage                    | 120VAC                                                                                                                                                                | 120VAC nominal (100/110/115/127 selectable)*** |                |                    |                          |
|                          | Waveform                   | Pure sine wave, 1U: <=3% THD (linear load), <=5% THD (non-linear load);<br>2U: <=2% THD (linear load), <=4% THD (non-linear load)                                     |                                                |                |                    |                          |
|                          | Frequency                  | 50/60Hz ± 0.3Hz                                                                                                                                                       | 50/60Hz ± 0.1Hz                                |                |                    |                          |
|                          | Efficiency                 | Up to 98%                                                                                                                                                             |                                                |                |                    |                          |
|                          | Overload capacity          | 1U online mode: >105% & ≤130% for 2min; >130% & ≤200% for 10sec; >200% for 250ms<br>2U online mode: >110% & ≤130% for 5min; >130% & ≤140% for 30sec; >140% for 1.5sec |                                                |                |                    |                          |
| BATTERY                  | Battery chemistry          | Sealed, maintenance-free lead acid                                                                                                                                    |                                                |                |                    |                          |
|                          | Battery size               | (4) 6V 290W                                                                                                                                                           | (2) 12V 9AH                                    | (3) 12V 9AH    | (4) 12V 9AH        | (6) 12V 9AH              |
|                          | Typical recharge / charger | <9 hours to 90%                                                                                                                                                       | <3 hours to 95% with 2A charger current        |                |                    |                          |
|                          | Charging current           | 1A                                                                                                                                                                    | 2A default, max 8A adjustable                  |                |                    |                          |
| PHYSICAL                 | Dimensions (W x D x H) **  | 17.2 x 17.8 x 1.7 in                                                                                                                                                  | 17.2 x 15.1 x 3.5 in                           |                | 17.2 x 19 x 3.5 in | 17.2 x 23.8 x 3.5 in     |
|                          | Weight                     | 28 lbs                                                                                                                                                                | 25.5 lbs                                       | 34.2 lbs       | 43 lbs             | 60.6 lbs                 |
|                          | Line cord                  | C14 inlet, 5ft 5-15P to C13 line cord                                                                                                                                 | 6 ft, 5–15P                                    |                | 6 ft, 5–20P        | 6 ft, L5–30P             |
|                          | Receptacles                | (3) NEMA 5–15R                                                                                                                                                        | (8) NEMA 5–15R                                 |                | (8) NEMA 5–15/20R  | L5–30R +<br>(6) 5–15/20R |
| ENVIRONMENT              | Operating temperature      | 32–104°F (0–40°C)                                                                                                                                                     |                                                |                |                    |                          |
|                          | Altitude                   | 11,500 ft above sea level                                                                                                                                             |                                                |                |                    |                          |
| APPROVALS                |                            | UL, cUL, RoHS, FCC Class B (1000VA [2U], 1500VA), FCC Class A (1000 VA [1U], 2000VA, 3000VA), TAA compliant (UPS only)                                                |                                                |                |                    |                          |
| WARRANTY                 |                            | 3 years electronics, 3 years battery warranty (USA and Canada)                                                                                                        |                                                |                |                    |                          |
| COMMUNICATIONS INTERFACE |                            | RS-232 (2U), USB, EPO,<br>intelligent slot for optional cards (Web/SNMP, Relay/dry contact)                                                                           |                                                |                |                    |                          |
| INCLUDED IN BOX          |                            | ViewPower software, 4-point rail kit with brackets, tower pedestals (2U models only), front brackets                                                                  |                                                |                |                    |                          |

\* Depending on load level.

\*\* Rack depth is front bracket to unit panel. Add 1" for depth including front bezel.

\*\*\* Capacities are based on highest selectable voltage. Some models derate at lower voltages.

| BATTERY RUN TIME (MINUTES) | Internal Batteries |      | External Battery Packs |      |     |      |     |      |     |      |     |      |     |      |     |      |
|----------------------------|--------------------|------|------------------------|------|-----|------|-----|------|-----|------|-----|------|-----|------|-----|------|
|                            |                    |      | 1                      |      | 2   |      | 3   |      | 4   |      | 5   |      | 6   |      | 7   |      |
| Percentage Load:           | 50%                | 100% | 50%                    | 100% | 50% | 100% | 50% | 100% | 50% | 100% | 50% | 100% | 50% | 100% | 50% | 100% |
| UPS9AC-1000                | 20                 | 8    | N/A                    | N/A  | N/A | N/A  | N/A | N/A  | N/A | N/A  | N/A | N/A  | N/A | N/A  | N/A | N/A  |
| UPS9A-1000                 | 6                  | 3    | N/A                    | N/A  | N/A | N/A  | N/A | N/A  | N/A | N/A  | N/A | N/A  | N/A | N/A  | N/A | N/A  |
| UPS9A-1500 (BP36)          | 10                 | 3    | 42                     | 17   | 84  | 33   | 120 | 51   | 157 | 72   | 199 | 93   | 244 | 112  | 289 | 128  |
| UPS9A-1500 (BP36E)         | 10                 | 3    | 84                     | 33   | 157 | 72   | 244 | 112  | 339 | 146  | N/A | N/A  | N/A | N/A  | N/A | N/A  |
| UPS9A-2000 (BP48)          | 10                 | 3    | 42                     | 17   | 84  | 33   | 121 | 51   | 157 | 72   | 200 | 93   | 244 | 112  | 290 | 128  |
| UPS9A-3000 (BP72)          | 10                 | 3    | 42                     | 17   | 84  | 33   | 121 | 52   | 158 | 73   | 201 | 94   | 246 | 112  | 292 | 129  |

**NOTE:** Maximum of seven battery packs per UPS9A-1500, UPS9A-2000, or UPS9A-3000 (excluding BP36E)

Approximate run times are shown in minutes and vary based on battery condition, age, cycles, and ambient temperature.



## A&E SPECIFICATIONS

(2U models): The uninterruptible power supply (UPS) shall be Lowell model \_\_\_\_\_ (UPS9A-1000, UPS9A-1500, UPS9A-2000, UPS9A-3000), which shall include a 4-point rackmount rail kit and tower pedestals. The chassis shall measure \_\_\_\_\_. The UPS shall feature input voltage/frequency of 50-150VAC/ 50/60Hz auto-sensing, depending on load level. Output voltage shall be 120VAC nominal (100/110/115/127 selectable, capabilities based on highest selectable voltage). Power rating shall be \_\_\_\_\_ (1000VA, 1500VA, 2000VA, 3000VA). The unit shall feature \_\_\_\_\_ receptacles and include a power cord with plug.

## INSTRUCTIONS

Download the user manual at [www.LowellMfg.com](http://www.LowellMfg.com)

### 4-POINT RACKMOUNT RAIL KIT

Mounting the UPS to a rack requires front and rear rack rails, as shown. Refer to the series summary chart (pg. 2) to obtain the minimum rack depth required for each UPS model. *Note: Minimum depths are provided for Lowell floor racks only.*

#### Lowell Floor Rack – 22"D min.

##### • UPS9AC-1000

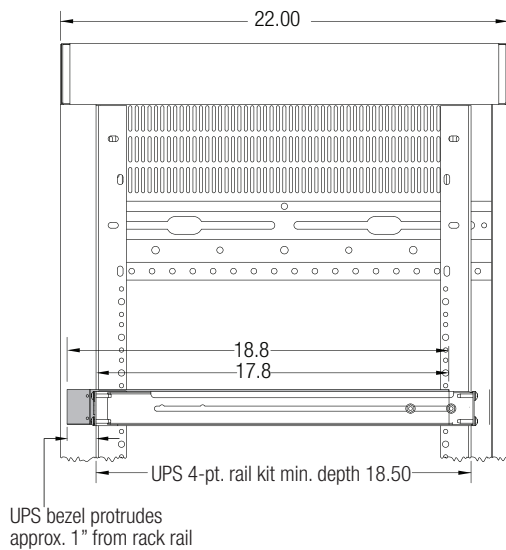

#### Lowell Floor Rack – 22"D min.

##### • UPS9A-1000, UPS9A-1500

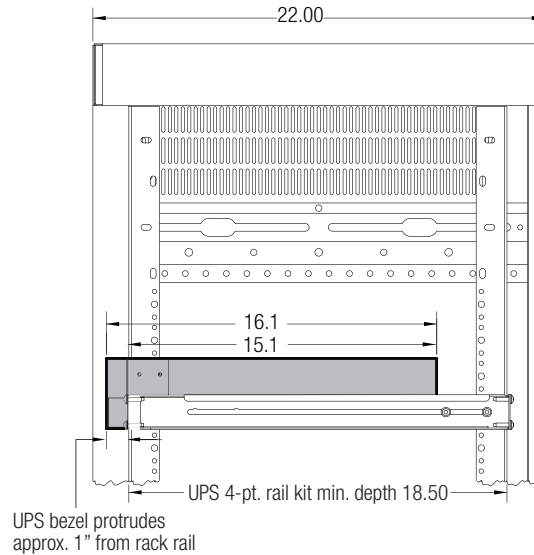

#### Lowell Floor Rack – 27"D min.

##### • UPS9A-2000

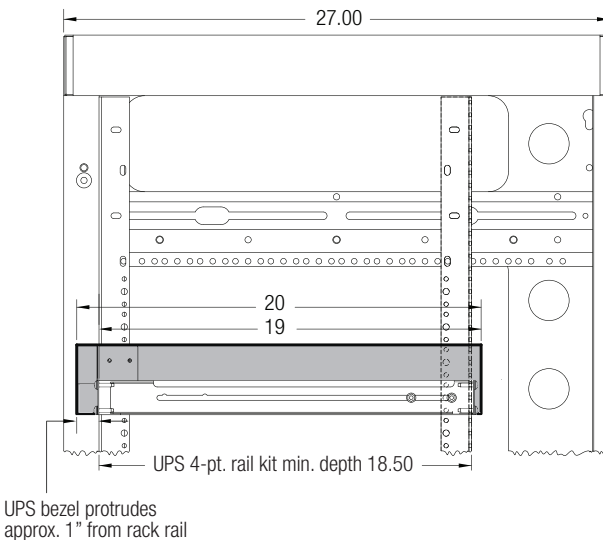

#### Lowell Floor Rack – 32"D min.

##### • UPS9A-3000

