



RDL®

High Performance Audio Products. Made in America.

Model D SERIES-RN02 Wall-Mounted Mic/Line Dante Interface 0 x 2



- Single-Gang Dante or AES67 Network Interface for Two Audio Outputs
- Two Balanced Outputs on Front Panel XLRs and on Rear Panel Detachable Wiring Block
- Front-Panel XLR Outputs are Software-Selectable for Mic or Line Level
- Outputs Equipped with Software-Controlled Attenuator in 1 dB Steps
- Module is Configured and Adjusted Using RDL CONSOLE or Other Network Control Software
- Compatible with RDL Network Remote Controls
- High Resolution 24 Bit Digital to Analog Conversion
- Legendary RDL Studio Quality, Low-Noise Performance

APPLICATION: The D-RN02 is a complete wall-mounted Dante or AES67 audio network interface. It features two balanced XLR mic or line outputs on the front panel and on a rear-panel detachable wiring block. The module is configured and adjusted using RDL CONSOLE or other network control software. The D-RN02 fits a standard US single-gang electrical box or an RDL WB-1U back box for installations in European or similar thinner walls. The D-RN02 is PoE powered and is available in multiple finishes with optional customized graphics.

Network to Mic/Line Outputs Section

Two Dante or AES67 audio channels are converted to balanced line level feeding front-panel XLR jacks and a rear-panel detachable wiring block. Each output provides balanced +4 dBu for a network digital audio level of -18 dBFS. Each output is equipped with a software-controlled attenuator adjustable in 1 dB steps to a maximum attenuation of 63 dB, then OFF. Each front-panel output is equipped with a software-controlled mic/line output attenuator pad. When an output is set to mic level, the step attenuator reduces the mic output in 1 dB steps to a maximum attenuation of 63 dB below mic level, then OFF.

Valid PoE power and synchronization to the Dante network are indicated by green LEDs visible from the front of the unit.

The D-RN02 is a professional grade product delivering studio-quality fidelity and low noise performance, coupled through XLR jacks housed in a steel chassis mounted with a powder-coated or stainless-steel Decora front plate.

The D-RN02's superior performance specifications make it ideally suited to installations requiring network control and exceptional value in commercial networked audio systems. This full-featured product is engineered and manufactured in the U.S.A. for continuous duty in demanding installations. Designed to outperform. Built to last.



RDL[®]

High Performance Audio Products. Made in America.

Model D SERIES-RN02 Wall-Mounted Mic/Line Dante Interface 0 x 2

This product is not specified to provide basic insulation from network cabling not installed wholly within the same building structure or terminated on equipment earthed to a different earthing network.

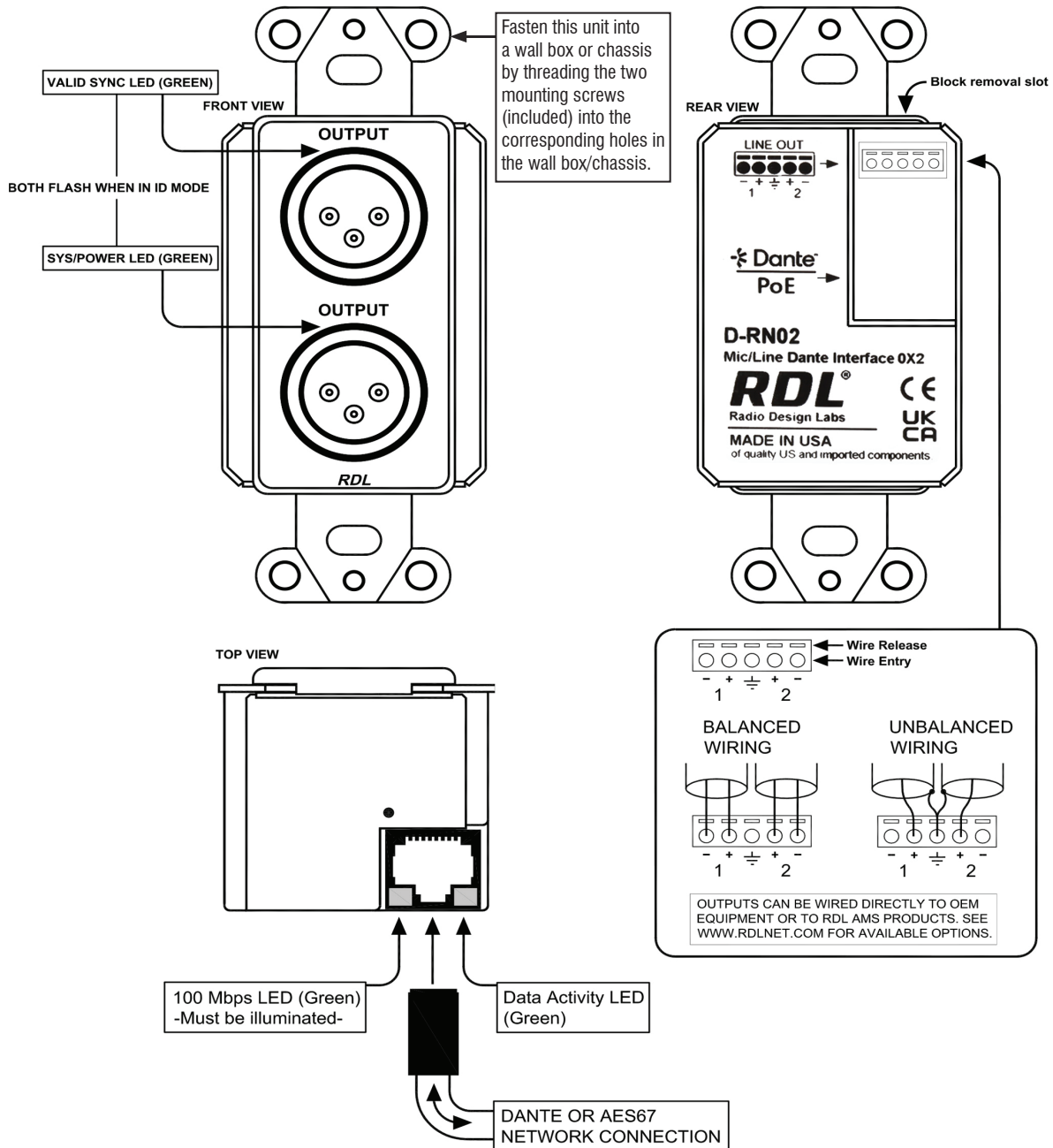

This product is not specified to provide basic insulation from network cabling not installed wholly within the same building structure or terminated on equipment earthed to a different earthing network.



RDL®

High Performance Audio Products. Made in America.

Model D SERIES-RN02 Wall-Mounted Mic/Line Dante Interface 0 x 2

Installation/Operation

CE Declaration of Conformity available from rdlnet.com.
Sole EMC specifications provided on product package.
Specifications are subject to change without notice.

TYPICAL PERFORMANCE

Network Connector: RJ45 with Link and Speed indicators
 Digital Audio Ethernet Protocol: Dante or AES67
 Transmission Rate: 100 Mbps
 Sample Rates Supported: 44.1 kHz, 48 kHz (default), 88.2 kHz, 96 kHz
 Bit Depth Supported: 24 bits
 Audio Operating Level: -18 dBFS = +4 dBu
 Reference Level: 0 dBFS = +22 dBu

Network to Mic/Line Outputs Section

Outputs (2): Balanced, XLR
 and detachable wiring block (2)
 Output Level (operating): +4 dBu (nominal) balanced
 Output Level (maximum): +22 dBu balanced
 Output Attenuator: Software-controlled,
 0 to -63 dB and OFF
 (analog output per received network channel)
 Output Impedance: 150 Ω balanced
 Frequency Response: Mic: 20 Hz to 20 kHz (± 0.5 dB);
 Line: 20 Hz to 20 kHz (± 0.5 dB)
 THD+N: < 0.1%
 THD: < 0.01% (1 kHz)
 Noise: < -80 dB (below +4 dBu); < -100dB
 (below +22 dBu)

Crosstalk: Below Noise Floor (20 Hz to 20 kHz
 at operating level, output to output)
 Headroom above +4 dBu: > 18 dB
 Indicators (4): Ethernet Link and Speed
 (2, rear panel); Sync and Power
 (2, front panel)
 Ambient Operating Environment: 0° C to 50° C
 Power Requirement: PoE Class 0, IEEE 802.3af
 Specification Conditions: Gain/Level: ± 1 dB;
 Source termination: 150 Ω
 Dimensions: 1.80" (4.57 cm) W;
 4.11" (10.44 cm) H;
 2.09" (5.31 cm) D
 Package Type: Cardboard Box
 Package Dimensions: 2.75" (6.99 cm) x
 6.7" (17.02 cm) x
 6.25" (15.88 cm)
 Shipping Weight: 0.69 lbs. (0.313 kg)
 WEEE weight: 0.43 lbs. (0.195 kg)

Safety Instructions/Consignes de sécurité/
Instrucciones de seguridad/Sicherheitshinweise:



EU Importer:
 Importateur de l'UE:
 Importador de la UE:
 EU-Importeur:
 RDL Europe B.V.
 Joan Muyskenweg 124
 1114 AN Amsterdam