

## MB-25B-BK

### RACK MOUNTING BRACKET

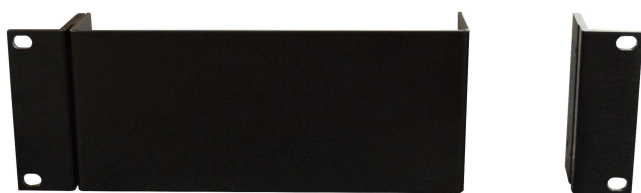

The MB-25B-BK panel is to mount a 2-unit size component that is 210 mm in width in an EIA component rack.

### Key features

\*UNDEFINED TEXT\*

## Specifications

Finish	Surface treated steel plate, black, 30% glossy, paint
Weight	300 g
Set Components	Mount bracket ..... 2, Blank panel ..... 1
Included Accessories	Unit mounting screw ... 1 set

## Dimensions

Rack Mounting  
Bracket

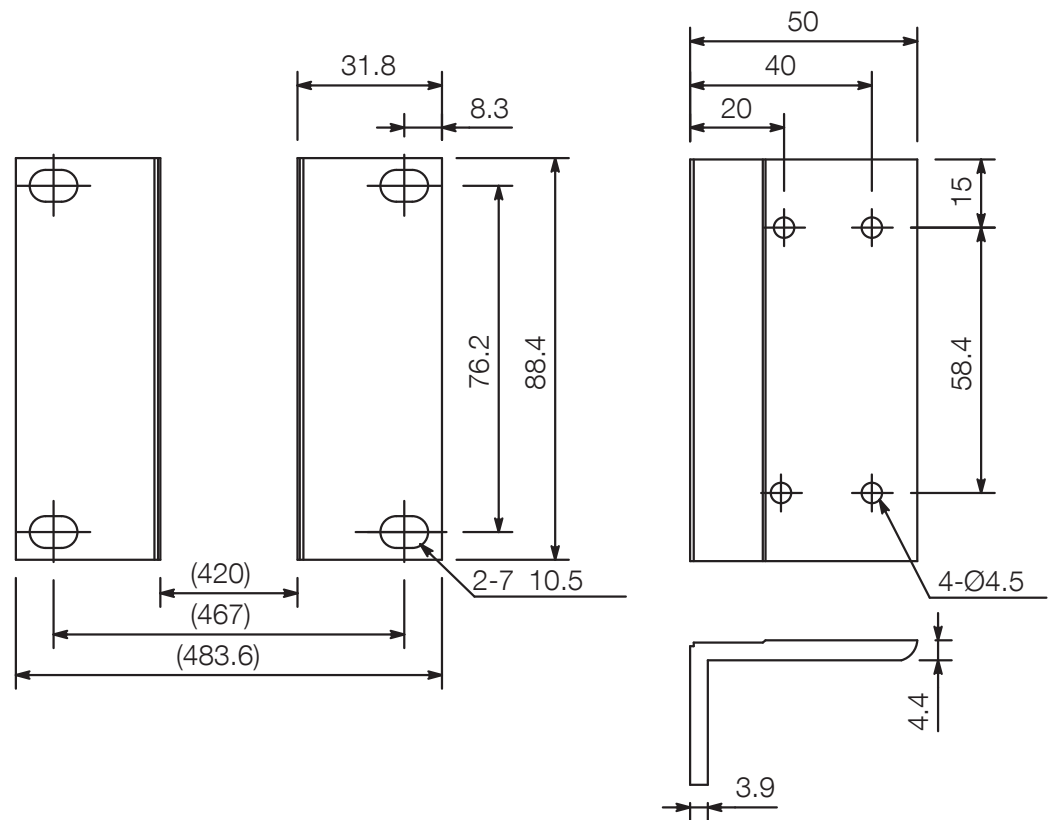

## Dimensions

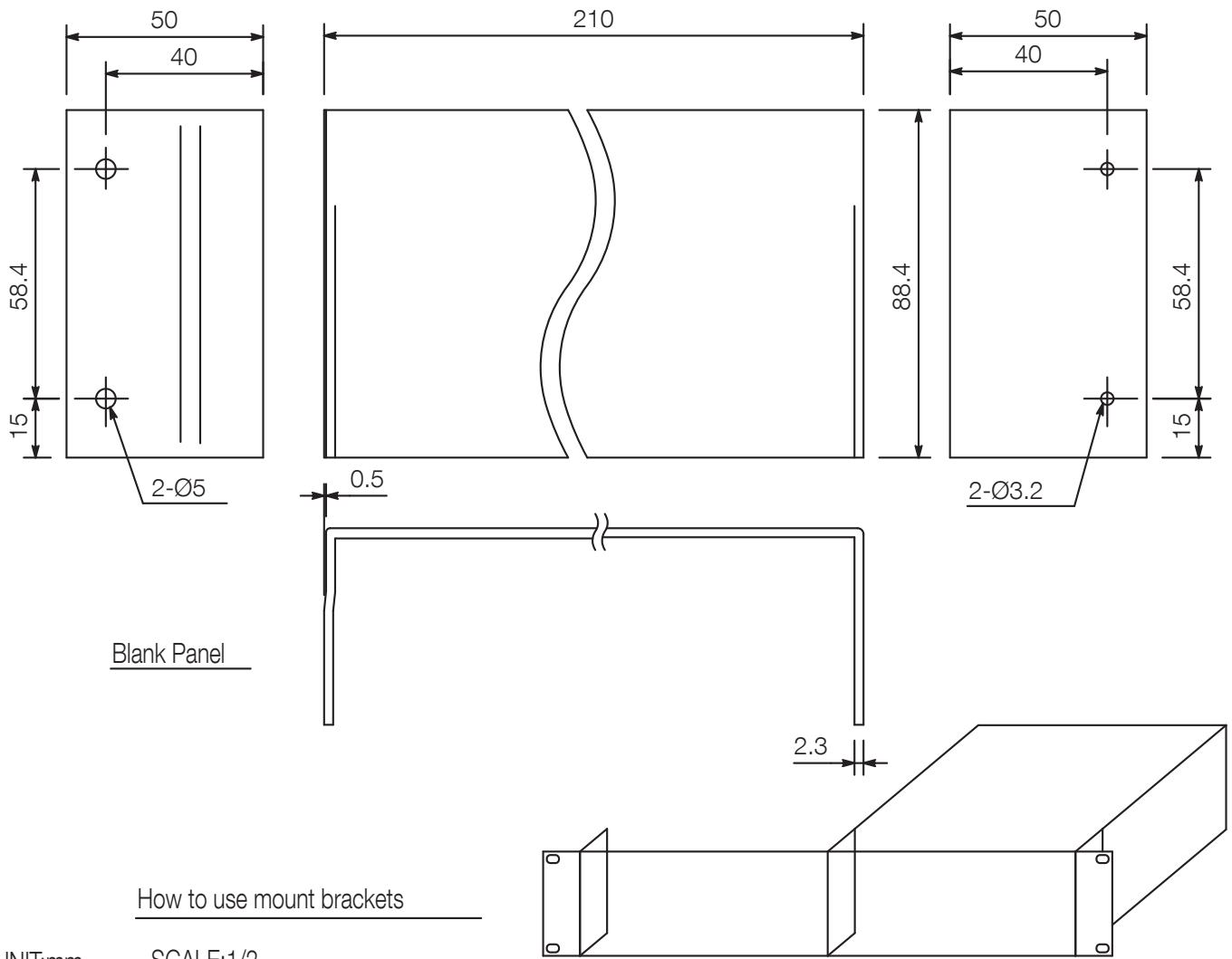

## A&E specifications

\*UNDEFINED TEXT\*