

SC-615

PAGING HORN SPEAKER



The SC-615 is a compact, highly intelligible speaker suited to public address announcement applications. Its external speaker component finished with powder coating, and stainless steel bracket and screws ensure the unit's weatherproof capability.

Key features

- Very rugged speaker with durable construction ensures long term reliable operation
- High quality sound
- Very high SPL
- Easy impedance selection through switch
- Low impedance 8 Ω
- Shock resistant oval horn

Specifications

Rated Input	15 W (Mobile Mount use: 10 W)
Rated Impedance	8 Ω
Sound Pressure Level	112 dB (1 W, 1 m at 500 Hz to 2.5 kHz peak level)
Frequency Response	280 Hz - 12.5 kHz
Polarity	Hot: Black , Com: White
Dust/Water Protection	IP65
Operating Temperature	-20 °C to +55 °C (-4 °F to 131 °F) (must be free from dew condensation)
Finish	Horn flare: Aluminum, off-white, powder coating Reflector horn and rear cover: ABS resin, off-white Bracket, screws and bolts: Stainless steel Speaker cable: Polyvinyl chloride insulated cabtyre cable (6 mm in diameter, 600 mm in length)
Dimensions	222 (W) x 179 (H) x 234 (D) mm
Weight	1.1 kg
Optional Accessories	Swivel bracket: YS-151S (Can be used instead of the supplied bracket.)

Note: Avoid installing the speaker in locations which vibrate considerably or under environments easy to be oil-contaminated.

Dimensions

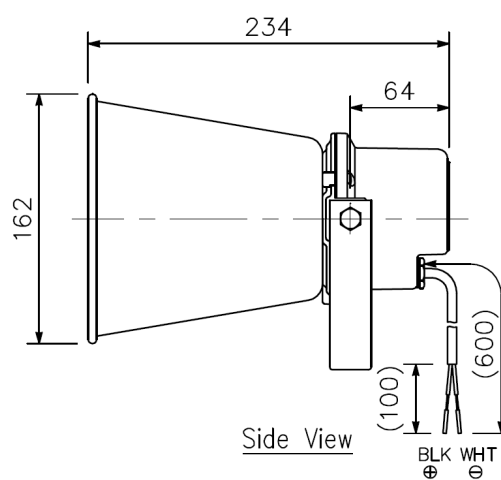
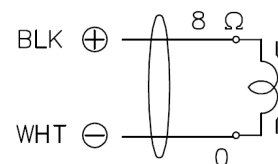
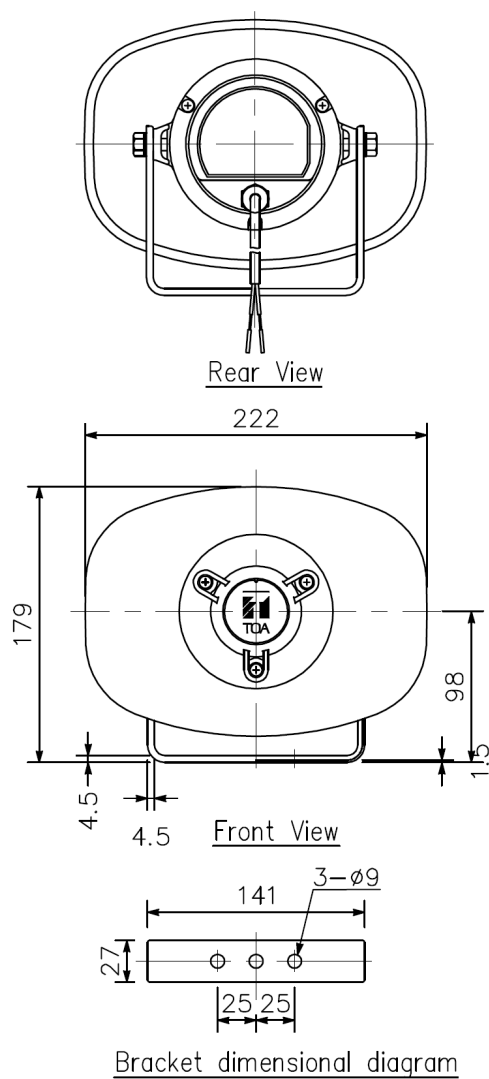

UNIT:mm

Note: Numerical values in parentheses are for reference only.

A&E specifications

Weather-resistant pressure chamber loudspeaker compliant with IP65, oval horn made of powder-coated aluminum, driver cover made of ABS plastic, swivelling bracket made of stainless steel for precise alignment of the speaker.

Rated power: 15 W Impedance: 8 ohm Frequency response: 280 – 12,500 Hz Sound pressure (1W/1m): 109 dB (peak 112dB)

Dimensions (W x H x D): 222 x 179 x 234 mm Operating temperature range: -20°C - +55°C Color: white (RAL 9010)

Manufacturer: TOA Model: SC-615